

ROOF SLOPE IN 12

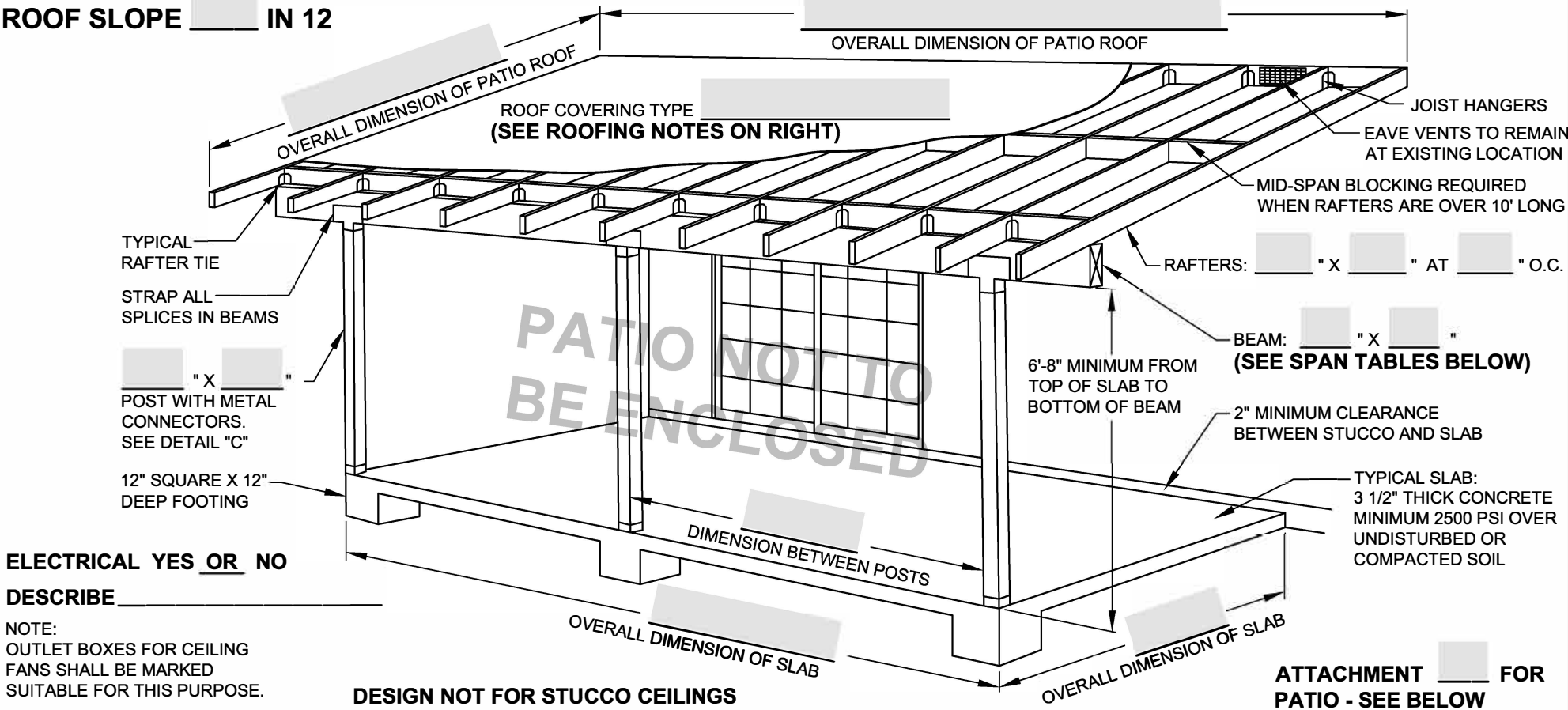

- ROOFING NOTES:**
- BUILT-UP TYPES INSTALLED PER MANUF. INSTRUCTIONS:
 - 2 LAYER - 15LB UNDERLAYMENT
 - 1 LAYER - 60LB CAP SHEET MOPPED (ROOFING PLIES) 90LB MINERAL SURFACED
 - TORCH DOWN ROOF SYSTEM PER MANUF. SPECIFICATIONS.
 - METAL OR TRANSLUCENT PANELS PER MANUF. SPECIFICATIONS. SLOPE AND CONNECTION PER MANUF. SPECIFICATIONS.
 - ASPHALT SHINGLES WITH 1 LAYER - 15LB UNDERLAYMENT SHALL HAVE 4:12 AND GREATER SLOPE. FOR SLOPES 2:12 AND UNDER 4:12 ASPHALT SHINGLES ARE SELF SEALING WITH 2 LAYERS OF 15LB UNDERLAYMENT APPLIED SHINGLE FASHION PER MANUF. SPECIFICATIONS.
 - CONCRETE TILE WITH 1 LAYER - 30LB UNDERLAYMENT SHALL HAVE 4:12 AND GREATER SLOPE. 2 LAYERS FOR 2.5:12 TO 4:12.
 - MINERAL SURFACED ROLL ROOFING PER MANUF. INSTRUCTIONS.
- GENERAL NOTES:**
- MATERIALS TO BE #2 DOUGLAS FIR MINIMUM.
 - ALL EXPOSED METAL (HANGERS, NAILS, ETC.) TO BE GALVANIZED.
 - CONCRETE FOOTINGS REQUIRED.
 - ROOF SHEATING 1/2" CDX OR 7/16" OSB MINIMUM - NAILING: 8d-6" O.C. EDGES AND 12" O.C. FIELD
 - EXPOSED ELECTRICAL SHALL BE INSTALLED IN APPROVED CONDUITS/ASSEMBLIES
- PLAN SUBMITTAL INFORMATION:**
- PROVIDE 1 COPY OF ALL DRAWINGS, OR DIGITAL SUBMITTAL.
 - SETBACKS SHALL MEET RESIDENTIAL ZONE REQUIREMENTS.
 - TO MEET MINIMUM BUILDING CODE REQUIREMENTS.
 - COMPLETE ALL GREY AREAS AND SELECT ATTACHMENT METHOD.
- INSPECTION ORDER:**
- ITEM #6, FOUNDATION
 - ITEMS #40 & #61 ROOF SHEATING (BEFORE COVERING ROOF).
 - ITEM #23, ROUGH FRAMING, #22 ROUGH ELECTRIC .
 - ITEM #24, LATH (FOR STUCCO) (POST OR BEAM ONLY) IF APPLICABLE.
 - ITEMS #41, #57 & #106, BUILDING FINAL - ALL EXTERIOR WOOD TO BE PRIMED/SEALED.

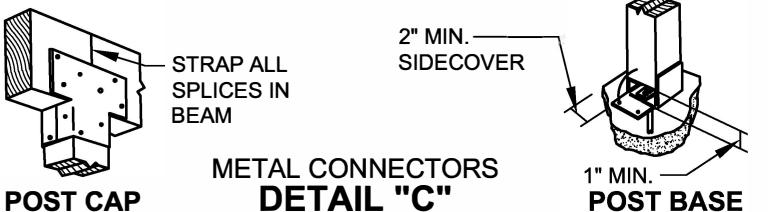
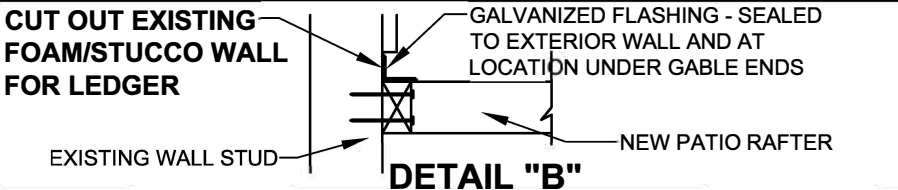
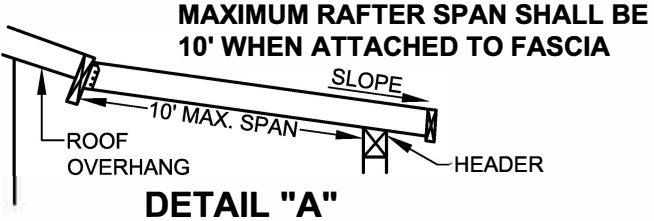

BEAM SPAN TABLE	
DISTANCE BETWEEN POST CENTERS:	MINIMUM BEAM DIMENSIONS:
4'	4" X 4"
6'	4" X 6"
8'	4" X 8"
10'	4" X 10"
12'	4" X 12"

RAFTER SPAN TABLE/FOR ROOF LOADS ONLY			
LUMBER SIZE	SPACING ON CENTER	MAX. SPAN DOUG. FIR #1	MAX. SPAN DOUG. FIR #2
2" X 6"	12"	17' - 4"	16' - 10"
	16"	15' - 4"	14' - 7"
	24"	12' - 6"	11' - 11"
2" X 8"	12"	22' - 5"	21' - 4"
	16"	19' - 5"	18' - 5"
	24"	15' - 10"	15' - 1"

